

Wall mounted socket DUO

Part no. 7602



- screw terminals
- for horizontal installation
- switched
- mechanical DUO-interlock
- sockets can be padlocked
- Conductor cross-section min.: 0,5 mm²
- Conductor cross-section max.: 4 mm²

Technical specifications

Ampere	16 A
Poles	3 p
Voltage	110 V
Clock position	4 h
Hertz	50-60 Hz
Connection technology	Screw terminals
Contact	standard
Protection type	IP44
Enclosure material	Plastic
Weight	1284 g
Certifications	EAC

Drawing

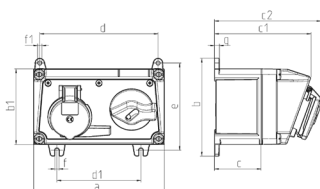

Drawing 1MB 550	Amp. Poles	16			32		
		3	4	5	3	4	5
Dim. in mm	a	225	225	225	225	225	225
	b	168	168	168	168	168	168
	b1	130	130	130	130	130	130
	c	80	80	80	80	80	80
	c1	166	166	166	166	166	166
	c2	182	183	183	193	193	193
	d	204	204	204	204	204	204
	d1	145	145	145	145	145	145
	e	150	150	150	150	150	150
	f	7	7	7	7	7	7
	f1	Ø7	Ø7	Ø7	Ø7	Ø7	Ø7
	g	8	8	8	8	8	8

Cable entries: closed for cut out. 2 x M 25 each on top and bottom,
2 x M 20 each on top and bottom for cut out.