

Cepex wall mounted socket

Part no. 4163



- screw terminals
- with labelling field
- with safety lock, two keys
- cannot be dismantled when locked
- on request with identical locks
- with identical lock: part no. + index G

Technical specifications

Ampere	16 A
Poles	4 p
Voltage	400 V
Clock position	6 h
Hertz	50-60 Hz
Protection type	IP44
Shutter	false
Weight	335 g

Drawing

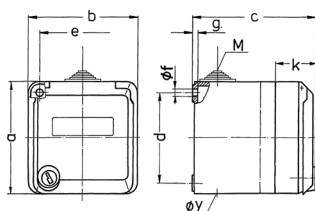

Drawing 1 MB 313	Amp. Poles	16			32		
		3	4	5	3	4	5
Dim. in mm	a	93	93	93	93	93	93
	b	90	90	90	90	90	90
	c	90	90	90	102	102	102
	d	75	75	75	75	75	75
	e	73	73	73	73	73	73
	f	5.5	5.5	5.5	5.5	5.5	5.5
	g	4.2	4.2	4.2	4.2	4.2	4.2
	k	36	36	36	36	36	36
	y	25.5	25.5	25.5	25.5	25.5	25.5
	M	25x1.5	25x1.5	25x1.5	25x1.5	25x1.5	25x1.5
Terminal for cond. cross		1.5	1.5	1.5	2.5	2.5	2.5
section (mm ²) min-max.		-4	-4	-4	-6	-6	-6