

## Panel mounted socket with TwinCONTACT

Part no. 1643



- screwless spring terminals
- suitable for through wiring
- 20° inclination

### Technical specifications

|                       |                         |
|-----------------------|-------------------------|
| Ampere                | 16 A                    |
| Poles                 | 5 p                     |
| Voltage               | 230 V                   |
| Clock position        | 9 h                     |
| Hertz                 | 50-60 Hz                |
| Connection technology | Screwless - TwinCONTACT |
| Contact               | standard                |
| Protection type       | IP44                    |
| Flange                | 100x92 mm               |
| Fixing hole           | 85x77 mm                |
| Inclination           | 20 °                    |
| Weight                | 164 g                   |
| Certifications        | VDE                     |

### Drawing

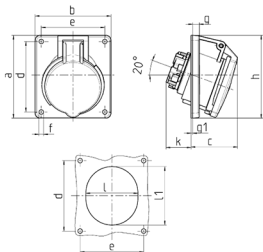

| Drawing<br>1 MB 465<br>Dim. in mm                                | Amp.<br>Poles | 16  |     |     | 32  |     |   |
|--|---------------|-----|-----|-----|-----|-----|---|
|  |               | 3   | 4   | 5   | 3   | 4   | 5 |
| a  | 73.5          | 100 | 100 | 100 | 100 | 100 |   |
| b  | 64            | 92  | 92  | 92  | 92  | 92  |   |
| c  | 52            | 58  | 58  | 61  | 61  | 60  |   |
| d  | 60            | 85  | 85  | 85  | 85  | 85  |   |
| e  | 52            | 77  | 77  | 77  | 77  | 77  |   |
| f  | 5.5           | 5.5 | 5.5 | 5.5 | 5.5 | 5.5 |   |
| g-   | 7             | 8   | 8   | 8   | 8   | 8   |   |
| g-1  | 2             | 2   | 2   | 2   | 2   | 2   |   |
| h  | 79            | 100 | 100 | 103 | 103 | 105 |   |
| k  | 31            | 31  | 31  | 44  | 44  | 54  |   |
| l  | 52            | 55  | 65  | 70  | 70  | 73  |   |
| l1   | 60            | 63  | 72  | 82  | 82  | 85  |   |
| Terminal for cond. cross<br>section (mm <sup>2</sup> ) min.-max. | 1.5           | 1.5 | 1.5 | 2.5 | 2.5 | 2.5 |   |
|  | -4            | -4  | -4  | -6  | -6  | -6  |   |